

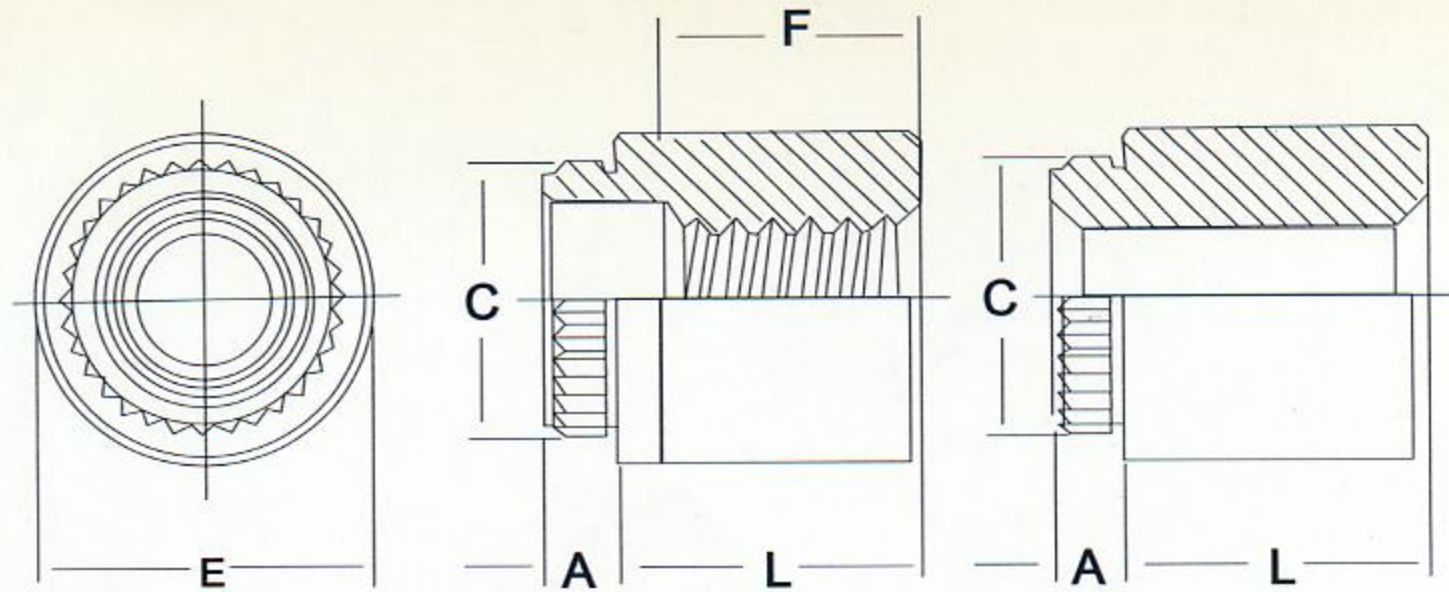

用于PC板的紧固件

JKFSE — M3 — 1
↓ ↓ ↓
型号 TYPE 螺纹尺寸 THREAD 底端码 SHANK CODE



尺寸单位:英寸
All dimensions are in inches.

UNIFIED (英制)	螺纹尺寸 Thread Size	通孔 Thru Hole +.004 -.003	型号 Type		螺纹/通孔代码 Thread or Thru Hole Code	长度Length "L" ±.005 Length Code in 32nds of an inch								A Max.	最小板厚 Min. Sheet Thickness	安装孔 Hole Size In Sheet +.003 -.000	C ±.003	E ±.005	最小边距 Min. Dist Hole C/L To Edge
			碳钢 Carbon Steel	不锈钢 Stainless Steel		.125	.250	.375	.500	.625	.750	.875	1.00						
	.112-40 (#4-40)	\	JKFE	JKFSE	440	4	8	12	16	20	24	NA	NA	.060	.060	.166	.184	.219	.17
	.138-32 (#6-32)	\	JKFE	JKFSE	632	4	8	12	16	20	24	28	32	.060	.060	.213	.231	.281	.22
	\	.116	JKFE	JKFSE	116	4	8	12	16	20	24	NA	NA	.060	.060	.166	.184	.219	.17
	\	.143	JKFE	JKFSE	143	4	8	12	16	20	24	28	32	.060	.060	.213	.231	.281	.22
"F" Minimum Thread Length (Where Applicable)						Full		.375 ±.016		.375Blind									

尺寸单位:MM
All dimensions are in millimeters.

METRIC (公制)	螺纹尺寸 X螺距 Thread Size x Pitch	通孔 Thru Hole +0.10 -0.08	型号 Type		螺纹/通孔代码 Thread or Thru Hole Code	长度Length "L" ±0.13 Length Code is in millimeters								A Max.	最小板厚 Min. Sheet Thickness	安装孔 Hole Size In Sheet +0.08	C ±0.08	E ±0.13	最小边距 Min. Dist Hole C/L To Edge
			碳钢 Carbon Steel	不锈钢 Stainless Steel		3	4	6	8	10	12	14	16						
	M3X0.5	\	JKFE	JKFSE	M3	3	4	6	8	10	12	14	16	1.53	1.53	4.22	4.68	5.56	4.4
	\	3.6	JKFE	JKFSE	3.6	3	4	6	8	10	12	14	16	1.53	1.53	5.41	5.87	7.14	5.5
	\	4.2	JKFE	JKFSE	4.2	3	4	6	8	10	12	14	16	1.53	1.53	6.4	6.86	8.74	7.1
"F" Minimum Thread Length (Where Applicable)						Full		9.5		±0.4									

NA Not available

用于PC板的紧固件系列